

**CITY OF PORT WASHINGTON, WISCONSIN
ORDINANCE 2016 - 1**

**AN ORDINANCE REZONING LAND WITHIN THE CITY OF PORT WASHINGTON
AND AMENDING THE OFFICIAL ZONING MAP**

WHEREAS, the City Plan Commission has requested rezoning of properties located at 722, 726-28, 734, 738-40, and 744 S. Spring Street from RM-2, Multi-family (Garden Apartment and Townhouse) to RM-1, Single and Two-family Residence); and

WHEREAS, the Plan Commission has reviewed all standards required to be considered by the Zoning Ordinance of the City of Port Washington and has recommended that said properties be rezoned by the Common Council; and

WHEREAS, all notices of said rezoning request and public hearing thereon have been given as required by said Zoning Ordinance and sec. 62.23(7)(d), Stats., and such public hearing was held before the Common Council on April 19, 2016; and

WHEREAS, the Common Council has determined that the rezoning of said lands will promote the public health, safety and general welfare of the community, and has directed that the zoning districts and Official Zoning Map of the City of Port Washington be amended to reflect the above-described zoning changes,

NOW, THEREFORE, the Common Council of the City of Port Washington, Wisconsin, do ordain as follows:

Section 1. That those certain lands located in the City of Port Washington, Wisconsin as more particularly located at 722, 726-28, 734, 738-40, and 744 S. Spring Street be hereby rezoned from RM-2 to RM-1.

Section 2. Pursuant to Sections 20.05.010, et seq., 20.21.060 and 20.23.000 of the Zoning Ordinance of the City of Port Washington, the Official Zoning Map shall be amended accordingly.

Section 3. This Ordinance shall become effective upon passage and publication.

Passed and approved this 19th day of April 2016.

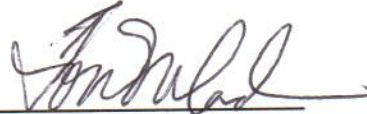

Tom Mlada, Mayor

ATTEST:



Susan Westerbeke, City Clerk

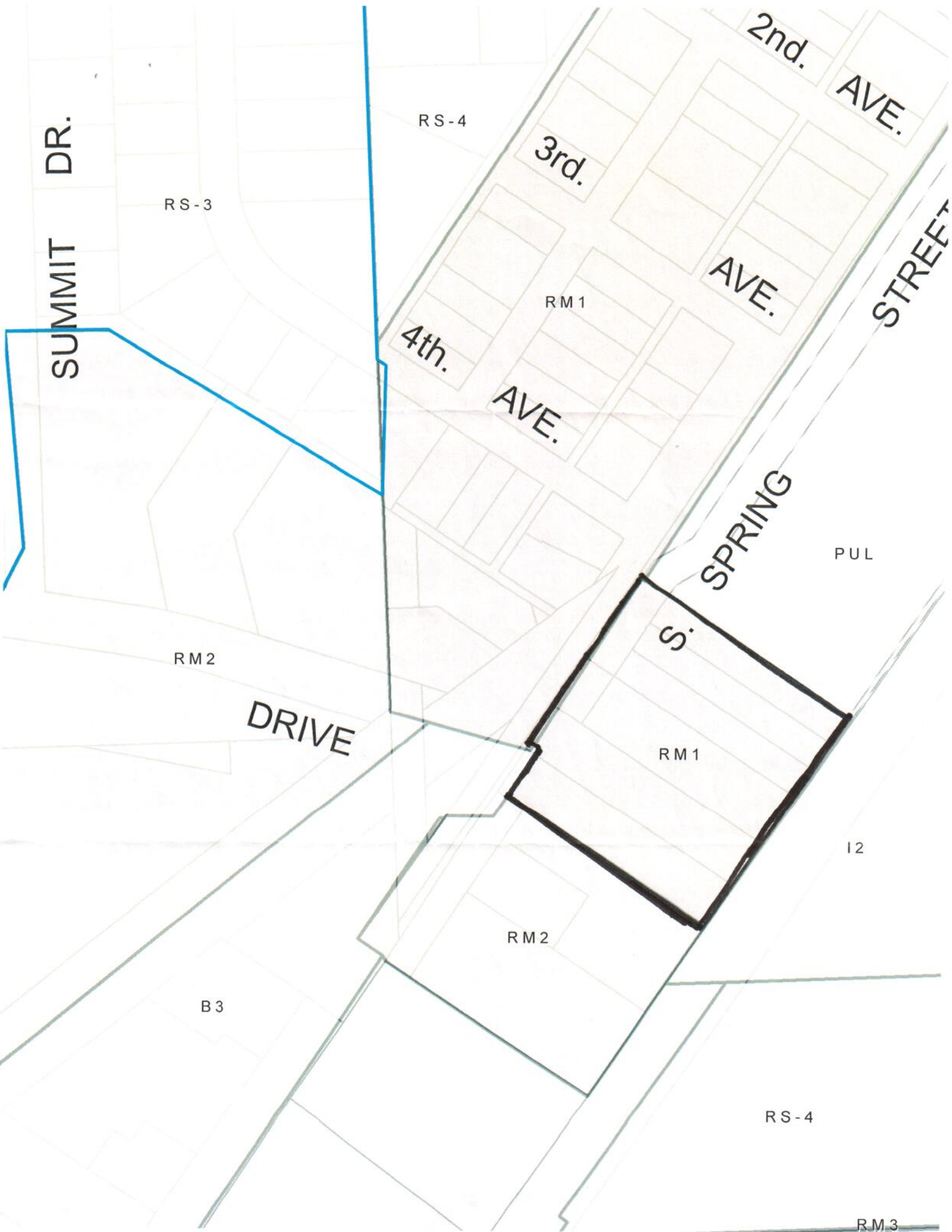

SUMMIT DR.

RS-3

RS-4

2nd. AVE.

3rd. AVE.

AVE.

RM1

4th. AVE.

STREET

S. SPRING

PUL

RM2

DRIVE

S.

RM1

I2

RM2

B3

RS-4

RM3

Legal Description

Being a part of NE ¼ of Section 32, Town 11 north, Range 22 East

City of Port Washington, Ozaukee County, Wisconsin

Lots 1 & 2 of Certified Survey Map #3970 (Doc. 1032644) **Taxkey:16-050-0703.008**

The south Fifty (50) feet of Lot Seven Hundred and three (703) Assessor's Plat to the City of Port Washington excepting that portion described in warranty Deed recorded April 26, 2001 at 8:30 am in Volume 1308 of Records on page 980 as Document No. 675657 **Taxkey:16-050-0703-005**

Lot Seven Hundred Five (705) in the Assessor's Plat of the City of Port Washington.
Taxkey:16-050-0705-000

Lot Seven Hundred Five (704) in the Assessor's Plat of the City of Port Washington.
Taxkey:16-050-0704-000

Lot Seven Hundred Six (706) in the Assessor's Plat of the City of Port Washington.
Taxkey:16-050-0706-000